



Series ST straight through couplings are designed for use where minimum pressure drop is required and valving is not needed. They are well suited for use on pressure wash, steam and carpet cleaning equipment, and many fluid transfer systems. Body sizes range from 1/8" to 2 1/2".

FEATURES

- Ball lock
- Manual operation
- Smooth bore permits free flow of liquid or gas
- Male and female NPTF, BSPP and hose stem connections

APPLICATIONS & MARKETS

- General Industry
- Fluid Transfer
- Chemical
- Food and Beverage
- Injection Molding
- Marine
- Military
- Carpet Cleaning
- Steam Cleaning
- Medical
- Food and Beverage
- Breathing Equipment
- Pressure Wash
- Cooling Systems



Flow Capacity

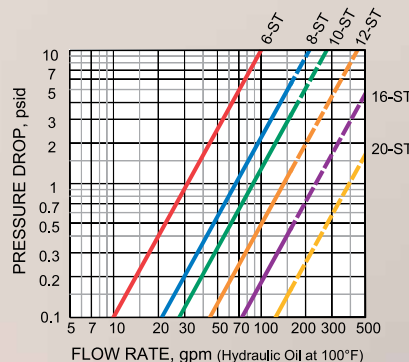
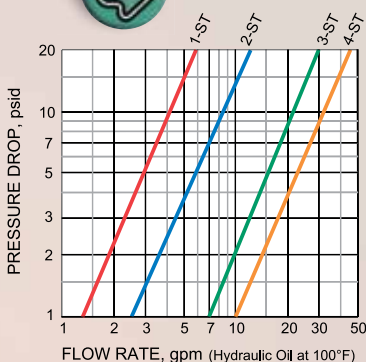

Interchangeability

- Other manufacturers' ST style couplings



Materials

- Brass or 303 stainless steel socket
- Stainless steel spring, balls and retaining ring
- Brass, zinc plated steel and 303 stainless steel plug
- High impulse heat treated 416 stainless steel plugs available in 1/4" and 3/8" body sizes
- Buna-N (Nitrile) seal; PTFE (1-ST through 8-ST), Neoprene, Fluorocarbon (FKM) and EPDM available



1/8" to 2 1/2" nominal
(3.175 mm to 63.5 mm)



-40° F to 250° F
-40° C to 121° C



Rated Pressure*

Series	Body Size	Brass Socket		Brass Socket Steel Plug		Stainless Steel Socket & Plug	
		PSI	BAR	PSI	BAR	PSI	BAR
1-ST	1/8"	2,800	193	3,400	234	4,200	290
2-ST	1/4"	5,200	359	5,500	379	7,500	517
3-ST	3/8"	2,800	193	4,200	290	6,300	434
4-ST	1/2"	2,200	152	3,500	241	3,600	248
6-ST	3/4"	1,700	117	2,100	145	3,000	207
8-ST	1"	1,300	90	2,000	138	2,000	138
10-ST	1 1/4"	1,700	117	2,700	186	2,200	152
12-ST	1 1/2"	1,400	97	2,200	152	2,500	172
16-ST	2"	1,400	97	2,200	152	1,500	103
20-ST	2 1/2"	900	62	1,500	103	-	-

* Pressure ratings are for sockets and plugs with threaded end connections. Pressure ratings of couplings with hose stems may be significantly lower, and will depend on the type of hose and the method of clamping. Refer to hose manufacturer's end connection pressure ratings. The best way to determine suitability for an application is to run pressure testing under controlled conditions.

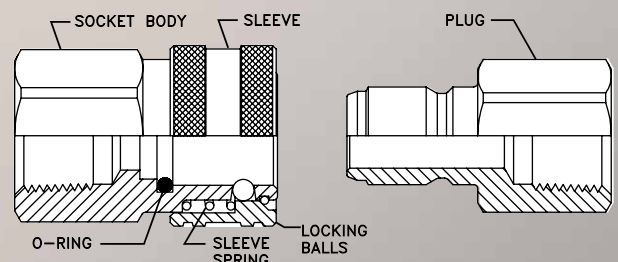

SERIES ST

SOCKETS

Male End Connections

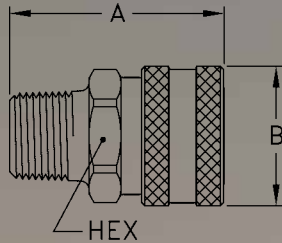

Body Size	Part Number		Thread Size		Dimensions		
	Brass	Stainless	NPTF	BSPP	A	B	Hex
1/8	1-S10	LL1-S10	1/8-27	—	1.06	0.72	0.56
1/8	1-S10BS	LL1-S10BS	—	1/8-28	1.08	0.72	0.56
1/4	2-S15	LL2-S15	1/4-18	—	1.72	0.97	0.81
1/4	2-S15BS	LL2-S15BS	—	1/4-19	1.56	0.97	0.81
3/8	3-S20	LL3-S20	3/8-18	—	1.75	1.16	1.00
3/8	3-S20BS	LL3-S20BS	—	3/8-19	1.71	1.16	1.00
1/2	4-S25	LL4-S25	1/2-14	—	2.03	1.34	1.13
1/2	4-S25BS	LL4-S25BS	—	1/2-14	1.85	1.34	1.13
3/4	6-S30	LL6-S30	3/4-14	—	2.22	1.72	1.44
3/4	6-S30BS	—	—	3/4-14	2.11	1.72	1.44
1	8-S35	—	1-11½	—	2.53	2.03	1.75
1	8-S35BS	—	—	1-11	2.43	2.03	1.75

Female End Connections

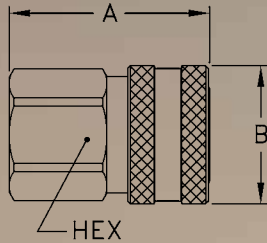

Body Size	Part Number		Thread Size		Dimensions		
	Brass	Stainless	NPTF	BSPP	A	B	Hex
1/8	1-S11	LL1-S11	1/8-27	—	1.06	0.72	0.56
1/8	1-S11BS	LL1-S11BS	—	1/8-28	1.03	0.72	0.56
1/4	2-S16	LL2-S16	1/4-18	—	1.50	0.97	0.81
1/4	2-S16BS	LL2-S16BS	—	1/4-19	1.50	0.97	0.81
3/8	3-S21	LL3-S21	3/8-18	—	1.59	1.16	1.00
3/8	3-S21BS	LL3-S21BS	—	3/8-19	1.59	1.16	1.00
1/2	4-S26	LL4-S26	1/2-14	—	1.91	1.34	1.13
1/2	4-S26BS	LL4-S26BS	—	1/2-14	1.91	1.34	1.13
3/4	6-S31	LL6-S31	3/4-14	—	2.06	1.72	1.44
3/4	6-S31BS	LL6-S31BS	—	3/4-14	2.06	1.72	1.44
1	8-S36	LL8-S36	1-11½	—	2.33	2.03	1.75
1	8-S36BS	LL8-S36BS	—	1-11	2.33	2.03	1.75
1¼	10-S41*	LL10-S41	1¼-11½	—	2.44	2.50	2.00
1¼	10-S41BS*	—	—	1¼-11	2.51	2.50	2.00
1½	12-S46*	LL12-S46	1½-11½	—	2.88	3.13	2.63
1½	12-S46BS*	LL12-S46BS	—	1½-11	2.88	3.13	2.63
2	16-S51*	LL16-S51	2-11½	—	3.09	3.75	3.00
2	16-S51BS*	LL16-S51BS	—	2-11	3.30	3.75	3.00
2½	20-S56*	—	2½-8	—	3.44	4.50	3.50

* With Steel Sleeve

Hose Stem Connections

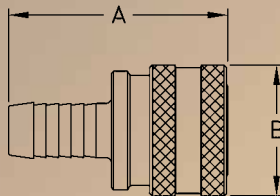

Body Size	Part Number		Hose I.D.	Dimensions	
	Brass	Stainless		A	B
1/8	1-S12	LL1-S12	3/16"	1.41	0.72
1/8	1-S17	LL1-S17	1/4"	1.41	0.72
1/4	2-S17	LL2-S17	1/4"	2.10	0.97
3/8	3-S22	LL3-S22	3/8"	2.09	1.16
1/2	4-S27	LL4-S27	1/2"	2.19	1.34
3/4	6-S32	LL6-S32	3/4"	3.19	1.72
1	8-S37	LL8-S37	1"	3.32	2.03

PLUGS

Male End Connections

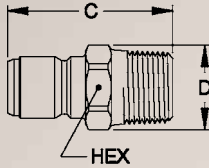

Body Size (inch)	Part Number			Thread Size (female)		Dimensions (inches)		
	Brass	Steel	Stainless	NPTF	BSPP	C	D	Hex
1/8	B1-T10	1-T10	LL1-T10	1/8-27	—	1.06	0.51	0.44
1/8	B1-T10BS	—	—	—	1/8-28	0.97	0.65	0.56
1/8	B1-T15	1-T15	—	1/4-18	—	1.22	0.65	0.56
1/4	B2-T15	2-T15	LL2-T15	1/4-18	—	1.56	0.65	0.56
1/4	—	—	HL2-T15*	1/4-18	—	1.56	0.65	0.56
1/4	B2-T15BS	—	LL2-T15BS	—	1/4-19	1.46	0.87	0.75
3/8	B3-T20	3-T20	LL3-T20	3/8-18	—	1.69	0.79	0.69
3/8	—	—	HL3-T20*	3/8-18	—	1.69	0.79	0.69
3/8	B3-T20BS	—	LL3-T20BS	—	3/8-19	1.59	1.01	0.88
1/2	B4-T25	4-T25	LL4-T25	1/2-14	—	2.01	1.01	0.88
1/2	B4-T25BS	—	LL4-T25BS	—	1/2-14	1.82	1.15	1.00
3/4	B6-T30	6-T30	LL6-T30	3/4-14	—	2.20	1.23	1.06
3/4	B6-T30BS	—	LL6-T30BS	—	3/4-14	2.08	1.44	1.25
1	B8-T35	8-T35	LL8-T35	1-11½	—	2.49	1.59	1.38
1	B8-T35BS	—	—	—	1-11	2.36	2.02	1.75
1¼	B10-T40	10-T40	LL10-T40	1¼-11½	—	2.72	2.02	1.75
1¼	B10-T40BS	—	—	—	1¼-11	2.55	2.31	2.00
1½	B12-T45	12-T45	—	1½-11½	—	3.31	2.60	2.25
1½	B12-T45BS	—	—	—	1½-11	3.19	2.60	2.25
2	B16-T50	16-T50	LL16-T50	2-11½	—	3.50	3.18	2.75
2	—	—	LL16-T50BS	—	2-11	3.54	3.18	2.75
2½	B20-T55	—	—	2½-8	—	4.24	3.75	3.25

Female End Connections

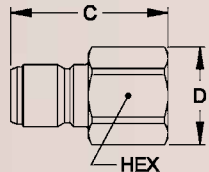

Body Size (inch)	Part Number			Thread Size (female)		Dimensions (inches)		
	Brass	Steel	Stainless	NPTF	BSPP	C	D	Hex
1/8	B1-T11	1-T11	LL1-T11	1/8-27	—	0.97	0.58	0.50
1/8	B1-T11BS	—	LL1-T11BS	—	1/8-28	0.97	0.65	0.56
1/4	B2-T16	2-T16	LL2-T16	1/4-18	—	1.45	0.79	0.69
1/4	—	—	HL2-T16*	1/4-18	—	1.45	0.79	0.69
1/4	B2-T16BS	—	LL2-T16BS	—	1/4-19	1.45	0.87	0.75
3/8	B3-T21	3-T21	LL3-T21	3/8-18	—	1.63	0.94	0.81
3/8	—	—	HL3-T21*	3/8-18	—	1.63	0.94	0.81
3/8	B3-T21BS	—	LL3-T21BS	—	3/8-19	1.63	1.01	0.88
1/2	B4-T26	4-T26	LL4-T26	1/2-14	—	1.92	1.15	1.00
1/2	B4-T26BS	—	LL4-T26BS	—	1/2-14	1.92	1.23	1.06
3/4	B6-T31	6-T31	LL6-T31	3/4-14	—	2.01	1.37	1.19
3/4	B6-T31BS	—	LL6-T31BS	—	3/4-14	2.01	1.52	1.31
1	B8-T36	8-T36	LL8-T36	1-11½	—	2.21	1.80	1.56
1	B8-T36BS	—	LL8-T36BS	—	1-11	2.23	1.80	1.56
1¼	B10-T41	10-T41	LL10-T41	1¼-11½	—	2.34	2.31	2.00
1¼	B10-T41BS	—	—	—	1¼-11	2.53	2.31	2.00
1½	B12-T46	12-T46	LL12-T46	1½-11½	—	2.88	2.60	2.25
1½	B12-T46BS	—	—	—	1½-11	2.88	2.60	2.25
2	B16-T51	16-T51	—	2-11½	—	3.03	3.18	2.75
2	B16-T51BS	—	—	—	2-11	3.25	3.18	2.75
2½	B20-T56	20-T56	—	2½-8	—	3.37	3.75	3.25

* High impulse heat treated 416 stainless steel

Hose Stem Connections

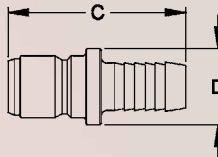

Body Size (inch)	Part Number		Hose I. D.	Dimensions (inches)	
	Brass	Stainless		C	D Ø
1/8	B1-T12	LL1-T12	3/16"	1.28	0.44
1/8	B1-T17	LL1-T17	1/4"	1.28	0.44
1/4	B2-T17	LL2-T17	1/4"	1.93	0.56
3/8	B3-T22	LL3-T22	3/8"	2.09	0.69
1/2	B4-T27	LL4-T27	1/2"	2.17	0.88
3/4	B6-T32	LL6-T32	3/4"	3.17	1.19
1	B8-T37	LL8-T37	1"	3.28	1.50

Dust Caps and Dust Plugs Accessories:



Series	Plug Dust Cap (Vinyl)	Socket Dust Plug (Vinyl)
2-ST	—	P-SDC-1-HK
3-ST	—	P-SDC-2-HK
6-ST	P-PDC-4-HK	P-SDC-4-HK
8-ST	P-PDC-6-HK	—
10-ST	P-PDC-8-HK	—